

OWNER'S TOPAZE™ MANUAL

Congratulations on your new TOPAZE from ZODIAC, the most powerful automatic suction cleaner, specially designed for standard above ground and flat-bottomed pools.

Zodiac, mastering the elements.

Renowned worldwide for the quality and reliability of its products in the aeronautical and marine sectors, Zodiac has now brought its expertise to swimming pools, to bring you a full range of pools, automatic pool cleaners and water treatment systems.

Backed by Baracuda technology, expertise and experience, Zodiac brings you the reassurance of top quality equipment in terms of both design and performance.

A real guarantee of efficiency and peace of mind!

Here is a list of the items contained in the pack and which you will need in order to install your TOPAZE:

① The TOPAZE suction cleaner →

② A circular yellow deflector wheel →

③ A grey disc →

④ 10 hose sections, each 1 metre in length →

⑤ 3 hose deflectors →

⑥ 1 hose adapter →

⑦ Three 45° elbows →

⑧ 1 flow tester →

⑨ weir adapter →

⑩ manual flow control valve →

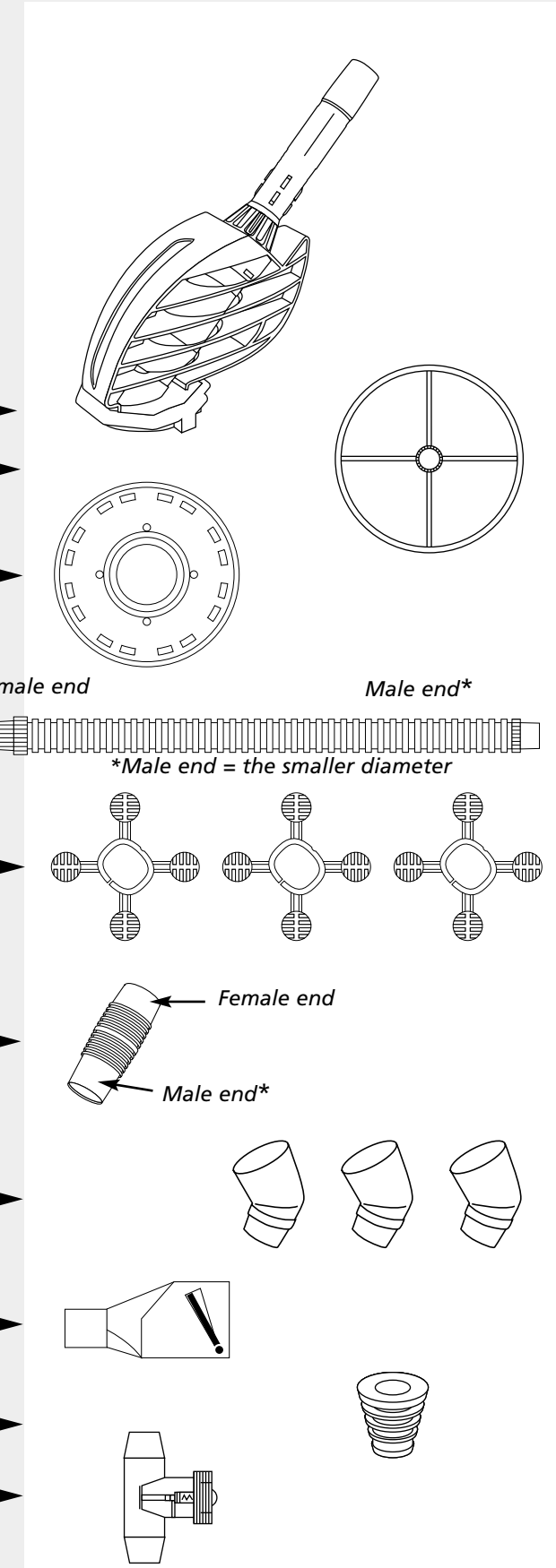

WARRANTY

Your TOPAZE is guaranteed 1 year for parts and labour against defects in manufacturing or materials with effect from the date of purchase. All other guarantee claims are excluded, except where specifically provided for under your statutory rights. A product shall only be deemed faulty if found defective by the ZODIAC assessors. Any claim must be accompanied by a supporting document clearly indicating the date on which the product was purchased. Both the product and the above-mentioned supporting document must be returned to us through the store from which you purchased the product.

ASSEMBLY

The cleaner is supplied partially assembled.
 ➔ All you have to do is fix the grey disc ③, with the side marked "Top" uppermost, on to the flexible foot. Make sure the disc is properly positioned in the throat of the flexible foot and that it can turn freely.

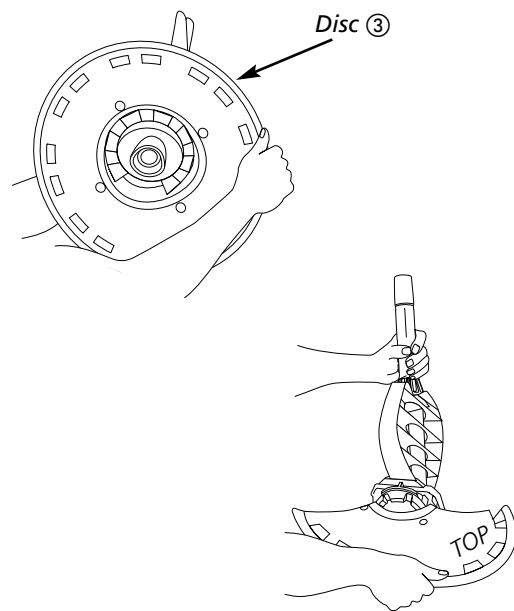

For standard above ground and flat-bottomed pools:
 Fix the deflector wheel ② on to the hose adapter ⑥ and then fit the female end of the adapter to the outer extension hose on the TOPAZE.

Installation on Zodiac pools in particular:
 A deflector wheel is not essential.

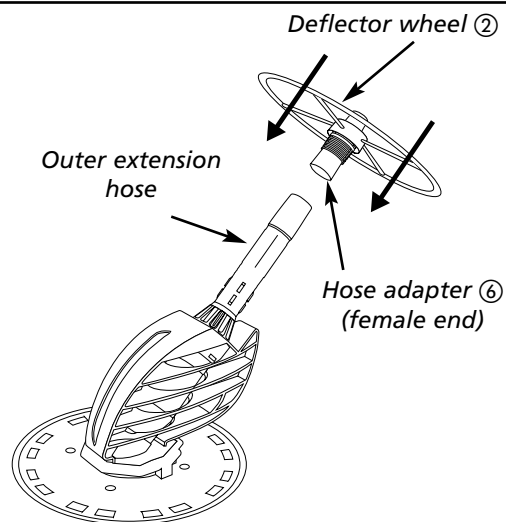

HOSE ASSEMBLY

The hose for your TOPAZE consists of a number of 1-metre sections ④.

- The length required for your pool equals 2 hose sections plus the longest distance your TOPAZE will need to cover in your pool, from the connection point, i.e. the skimmer, to the furthestmost bottom corner of the pool.

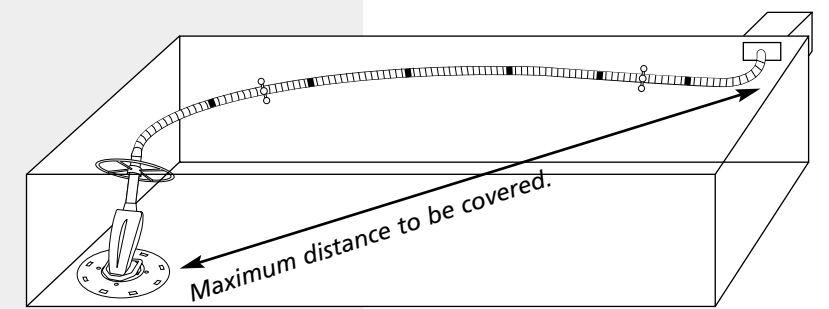

Length of hose = maximum distance + 2 sections of 1 metre.

- Once you have worked out the total length required, assemble the hose by fitting the sections together.
- Place the first hose deflector ⑤ in the middle of the second hose section ④, going from the unit, and the second hose deflector ⑤ in the middle of the last but one section ④. With large pools, you can if necessary place the third hose deflector between defectors 1 and 2.
- Connect the hose to the TOPAZE. To do this, fit the female end of the hose to the male end of the adapter, which is already fitted to the unit.

N.B.:
 TOPAZE travels around the pool at random, i.e. as dictated by the twists and turns of the hoses. It is important to place the hose deflectors in the right position as this affects the behaviour of the hoses and makes it easier for the TOPAZE to move around at random. (Don't hesitate to adjust the initial position of the hose deflectors; you can move them further away or bring them closer together.) These deflectors are not floats; their job is to ensure that the unit moves around the pool properly and efficiently.

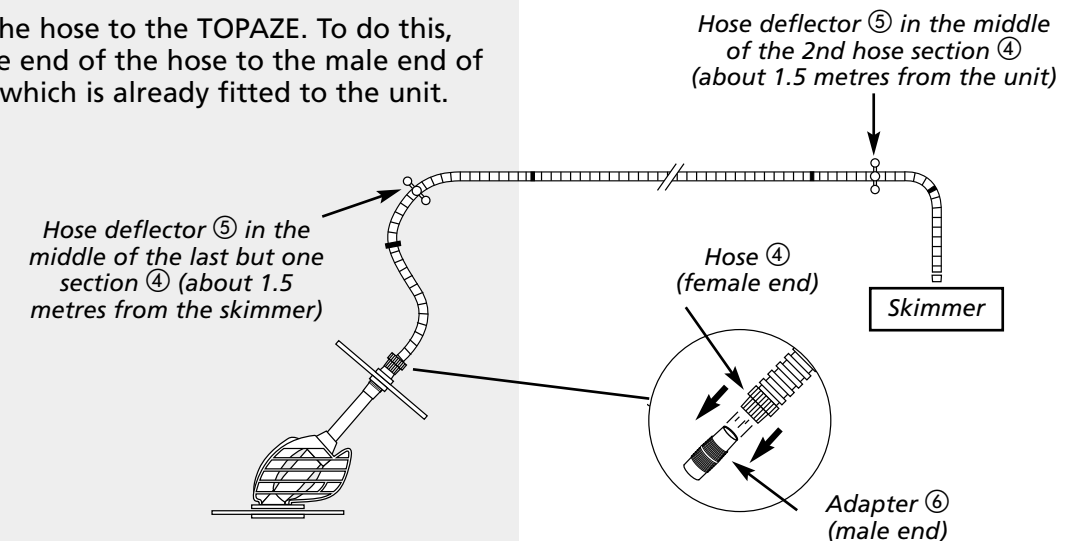

INSTALLATION

Fit the three elbows ⑦ together and then fit them to the male end of the hose ④ which is not connected to the TOPAZE.

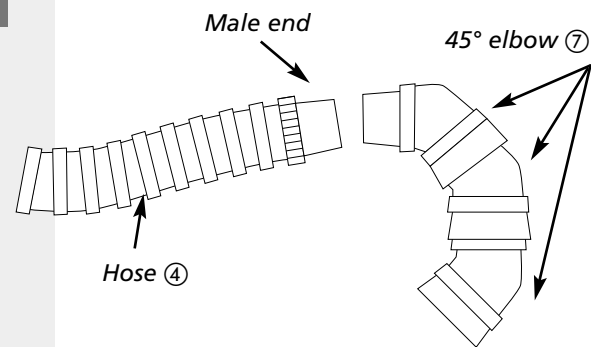

Installation on standard above ground and flat-bottomed pools.

- Check that the filtration system is working properly and that the skimmer, the filter and the prefilter in the pump are all clean.
- Close down the filtration system.
- Position the skimmer flap inside the pool.
- Remove the skimmer cover.
- So as to prevent the pump from draining, carefully draw off any air contained in the TOPAZE hose. To do this, fill the hose with water by immersing it in the pool. To fill the hose quickly, place the end of it on to your pool's inlet nozzle, whilst the pump is operating.
- Fit the manual flow control valve ⑩ into the skimmer, using the weir adapter ⑨. By turning the head of the valve clockwise or anticlockwise, you increase or reduce both flow and travelling speed (normal speed = 5 - 6 metres/minute).

Important: the valve must remain submerged at all times, otherwise air will be sucked in by the pump.

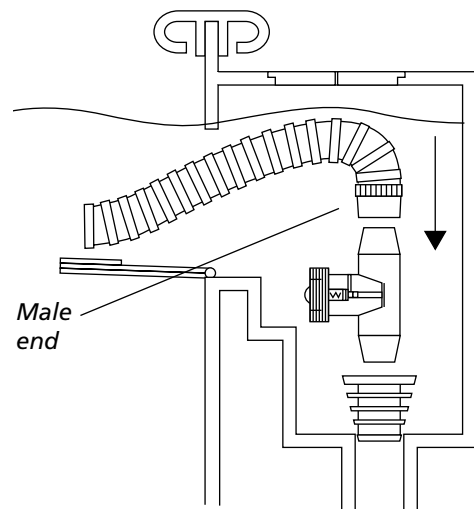

IMPORTANT : It is essential to carry out a flow test after every connection

Installation on ZODIAC pools in particular.

- Check that the filtration system is working properly and that the skimmer, the filter and the prefilter in the pump are all clean. (For the correct installation of the skimmer in your ZODIAC pool, see the instructions provided with the skimmer.)
- Close down the filtration system.
- So as to prevent the pump from draining, carefully draw off any air contained in the TOPAZE hose. To do this, fill the hose with water by immersing it in the pool.
- Fit the three elbows ⑦ fixed to the TOPAZE hose on to the sweeper adapter supplied with your ZODIAC pool skimmer.
- Start the pump up.
- Install the sweeper adapter with the three elbows to your ZODIAC pool skimmer. (To fit the sweeper adapter to the skimmer, see the instructions provided with the skimmer.)

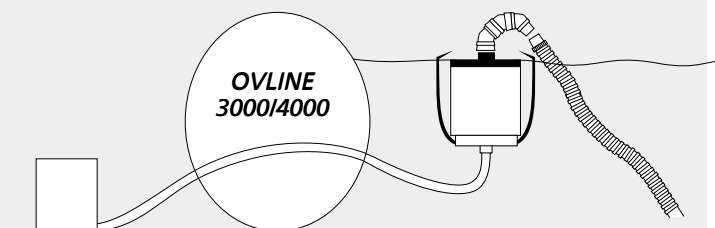

IMPORTANT : It is essential to carry out a flow test after every connection

Example with fixed skimmer:

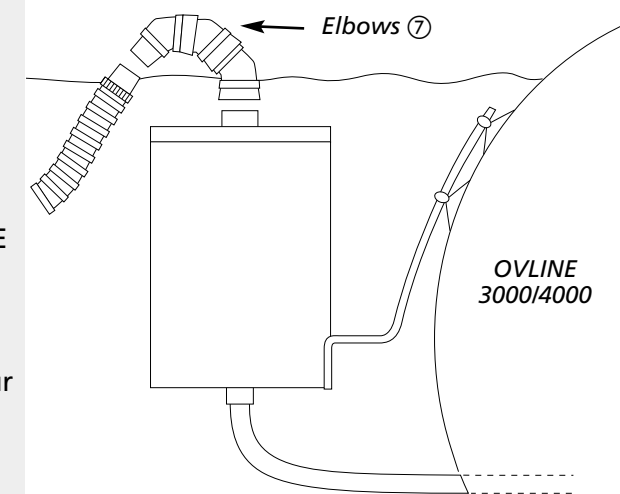

Example with floating skimmer:

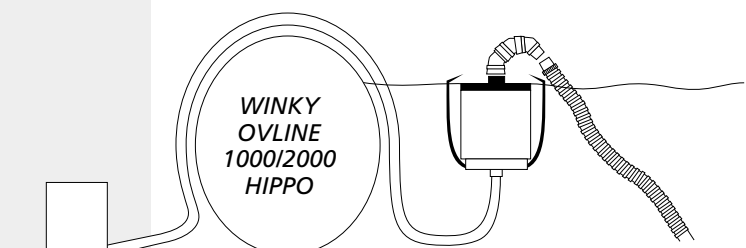

FLOW TEST

The purpose of the flow test is to check that the flow in your system is sufficient to ensure that your TOPAZE works efficiently.

N.B: All operations to be carried out below the surface of the water so as to prevent your pump from sucking up any air.

- Disconnect your TOPAZE ① from its hose ④ and replace it with the flow tester ⑧.

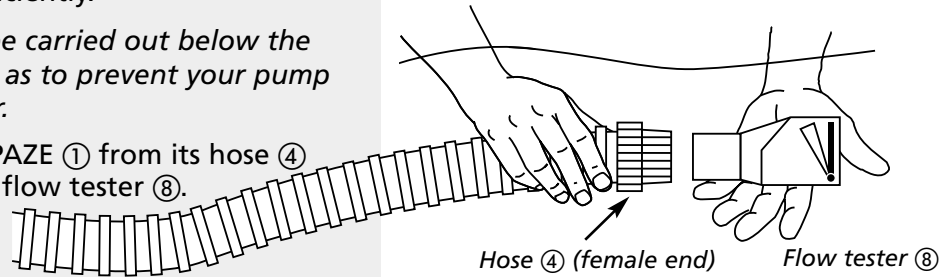

- Observe the area indicated by the tester:

Ideal scenario :

Flow is perfectly suitable for your TOPAZE. Remove the tester ⑧ and reconnect the unit to the hose ④.

Flow rate too high :

The capacity of your pump is too high. Over and above 1.5 h.p. (1.2 kW), pump capacity is too great for the TOPAZE to work at optimum efficiency; the same applies to pumps delivering over 20m³/hour. To reduce flow, open the manual flow control ⑩ valve until the pool pulse indicator is in the required area. Remove the pool pulse ⑧ and connect the unit to the hose ④.

Minimum situation :

To increase flow, close the manual flow control valve ⑩ until the pool pulse indicator is in the required area. Remove the pool pulse ⑧ and connect the unit to the hose ④.

max. min.

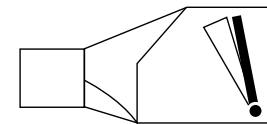
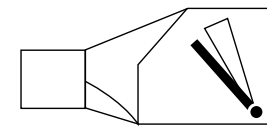
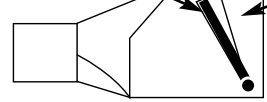

RECOMMENDATIONS

During the season, you can safely leave your TOPAZE in the water. (But take care with the hose: never leave it in direct sunlight; leave it either in the water or in a cool sheltered place.)

Take care when shocking your pool.

Don't wait until your pool is very dirty and full of algae before using your TOPAZE: the filtration system could very quickly become clogged.

Don't allow large pieces of dirt or litter to remain at the bottom of your pool: they could obstruct the diaphragm in the unit.

Avoid all obstacles that could in any way clog the unit.

A water temperature of under 20°C reduces the efficiency of the TOPAZE, which anyway will not work in water with a temperature of less than 16°C.

MAINTENANCE / STORAGE

The TOPAZE requires very little maintenance:

- After each use, check the diaphragm for clogging.
- Check the hoses for possible obstructions.

IMPORTANT:

During the season, it is advisable to leave the TOPAZE in the pool. If you wish to take it out of the water while bathing, disconnect the hose, but don't coil it up and never expose it to direct sunlight.

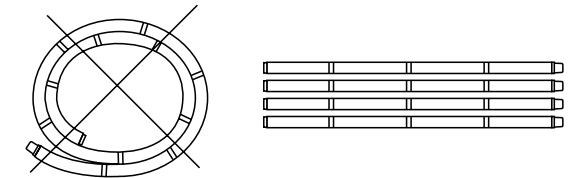

WINTER STORAGE

Clean the entire unit and the hoses with clean water. Allow to dry and store them in a dry frost-protected area.

TROUBLESHOOTING

1 / TOPAZE isn't working.

Check the flow

If the flow is insufficient
(TOPAZE not adhering to the bottom of the pool):

- ➔ ● Check that your filtration system is working properly and that the multiport valve is in the filtration position.
- ➔ ● Check that the prefilter basket and the filter are both clean.
- ➔ ● Check the pump turbine for impurities.
- ➔ ● Check the suction hose connection.
- ➔ ● Check the capacity of your pump: the minimum flow required should be in the region of 5m³/hour.
- ➔ ● To increase suction, adjust the manual flow control valve.

If the flow is too high
(TOPAZE stays sucking away at the bottom of the pool):

- ➔ Reduce suction using the manual flow control multiport valve.

If flow is as it should be:

- ➔ ● Check that your filtration system is working properly and that the multiport valve is in the filtration position.
- ➔ ● Check the pump turbine for impurities.
- ➔ ● Check the suction hose connection.
- ➔ ● Check that the prefilter basket and the filter are both clean.

- ➔ ● Check that the suction system (the diaphragm 8) is not clogged by any litter.
To do this, disconnect the outer extension pipe 3 and the housing 5 from the body of the TOPAZE 6 by undoing the outer extension pipe ring. Unscrew the outer extension pipe 3 and push on the inner extension pipe 10 so as to reveal the diaphragm 8. Remove any litter clogging the diaphragm 8 or caught inside the inner extension pipe 10. Refit the inner extension pipe 10 and screw the outer extension pipe 3 back again.

- ➔ ● Check that the suction system (the diaphragm 8) has not been damaged by sharp-edged items of litter and that the diaphragm itself is not worn following intensive use of the unit.

In either case, replace the diaphragm as follows:

Disconnect the outer extension pipe 3 and the housing 5 from the body of the TOPAZE 6 by undoing the outer extension pipe ring.

Unscrew the outer extension pipe 3.

Push on the transparent inner extension pipe 10 so as to reveal the diaphragm 8.

Remove the damaged diaphragm together with the retaining ring 9.

To fit the new diaphragm 8, follow the above steps in reverse order:

Fit the retaining ring 9 to the new diaphragm 8, and fit the new diaphragm to the transparent inner extension pipe 10. Fit the diaphragm 8 into its housing by pulling on the transparent inner extension pipe 10. Then screw the outer extension pipe 3 back in again. Refit the assembly into the body of the TOPAZE 6 and screw the ring of the outer extension pipe 3 back in place, forcing it down on the stop until it is completely tight.

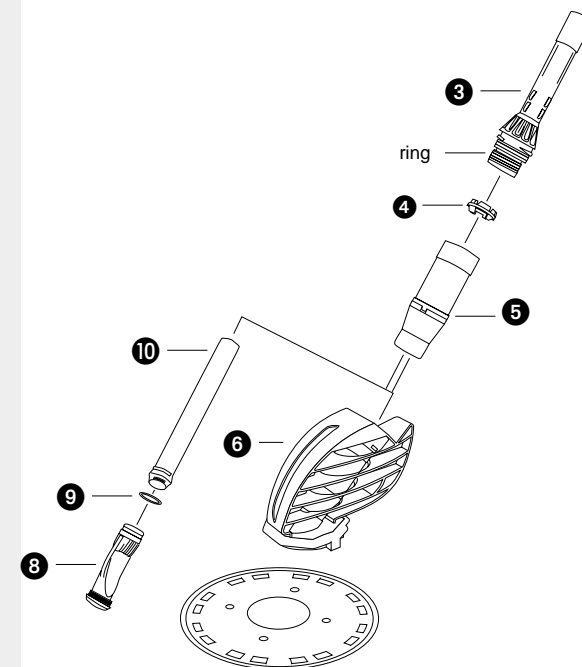

2 / TOPAZE isn't covering every area of the pool.

- ➔ ● To ensure complete cleaning, you can reduce filtration times. For example, 6 hours' filtration broken up into 3 two-hour periods will give better pool coverage than a single six-hour filtration operation.
- ➔ ● Is your hose long enough? Add further sections if necessary.
- ➔ ● Is the hose in really good condition? See Page 19, storage recommendations.
- ➔ ● If your pool includes inlet jets, point them downwards.
- ➔ ● Adjust the position of the hose deflectors so as to change the TOPAZE's movement pattern.

3 / TOPAZE stays stuck on the steps.

- ➔ ● Check that the deflector wheel is fitted. If not, fit it.
- ➔ ● Pull the steps as far as possible to the edge of the pool, or even remove them if necessary.

4 / TOPAZE often climbs the walls above the water line.

- ➔ ● Reduce flow using the manual flow control valve.

5 / TOPAZE moves along very slowly and bubbles appear at the inlet.

- ➔ ● Check the entire system for airtightness: between the unit and the hose, between all hose sections and the adapter, between the adapter and the skimmer and between the skimmer and the filter.

PARTS LIST

Réf.	Code	Description	Quantity
1	W 32305	Hose adapter	1
2	W 69037	Deflector wheel	1
3	W 72042	Outer extension hose	1
4	W 74000	Compression ring	1
5	W 69205	Diaphragm housing	1
6	W 69032	Body of the Topaze	1
7	W 69038	Disc	1
8	W 81710	Diaphragm	1
9	W 81600	Retaining ring	1
10	W 56525	Inner extension hose	1
11	W 38805	1-metre hose section	10
12	W 24206	Hose deflector	3
13	W 22410	45° elbow	3
14	W 44800	Flow tester	1
15	W 63900	Weir adapter	1
16	W 44105	Manual flow control valve	1

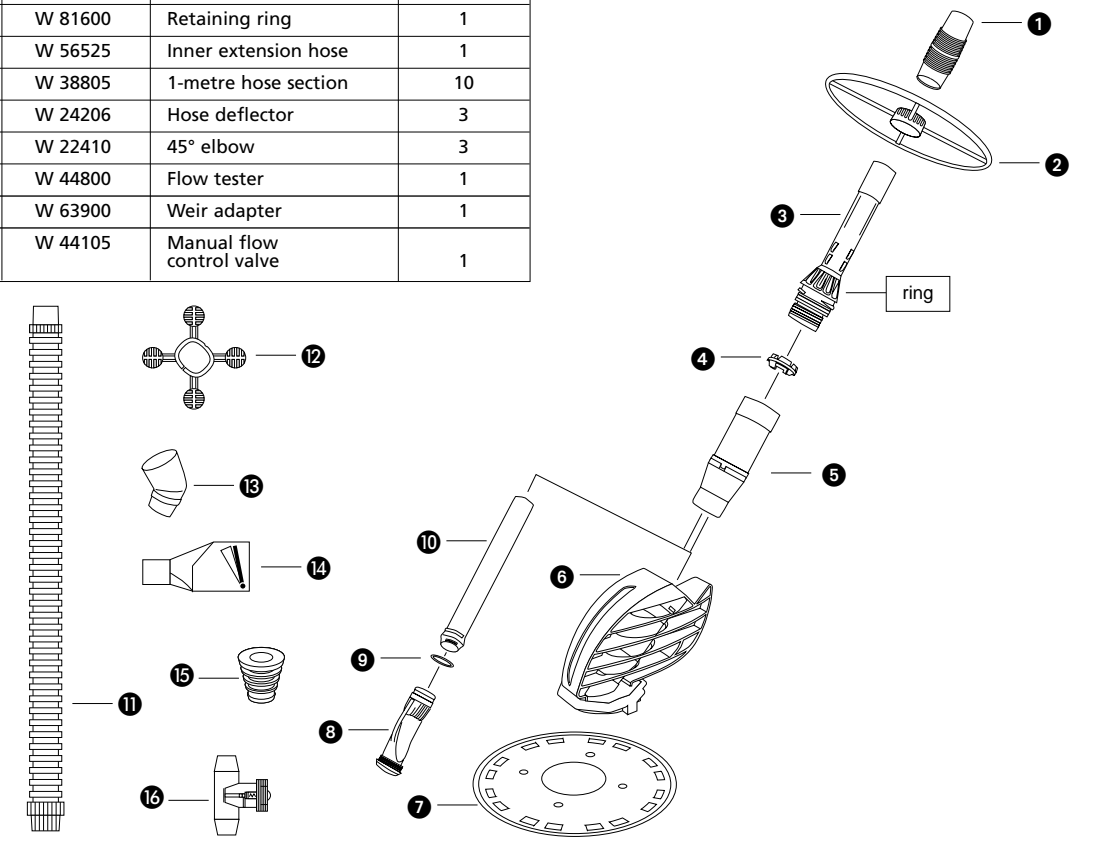

ZODIAC
Head Office and Sales Department:
 2, rue Maurice Mallet - 92130 ISSY-LES-MOULINEAUX - FRANCE - Tel. (0)1 41 23 23 06 - (0)1 41 23 24 00
Customer Service:
 BP n°1 - rue du Colonel Bouvet - 68530 BUHL - FRANCE - Tel. (0)3 89 62 14 31
 Public company, registered capital 3 200 000 Euros - Companies' Register:324 348 077 Nanterre
<http://www.zodiacpools.com>