



TECHNICAL GUIDE

Suction cleaners





SUMMARY

I- SALES PRESENTATION.	P. 3
II- TECHNICAL TIPS & HINTS.	P. 10
III- AFTER SALES SERVICE: ASSEMBLY / DISMANTLING.	P. 15
IV- SPARE PARTS.	P. 20



Part 1: SALES PRESENTATION

1. Suction technology (reminder).
2. Comparative Guide to Polaris Suction Cleaners.
3. Presentation of models available.



1. Suction technology

- **Power source:**
Filter pump
- **Connection:** skimmer or
sweeper point
- **No additional
installation needed**
- **Collection of debris:**
Pump basket

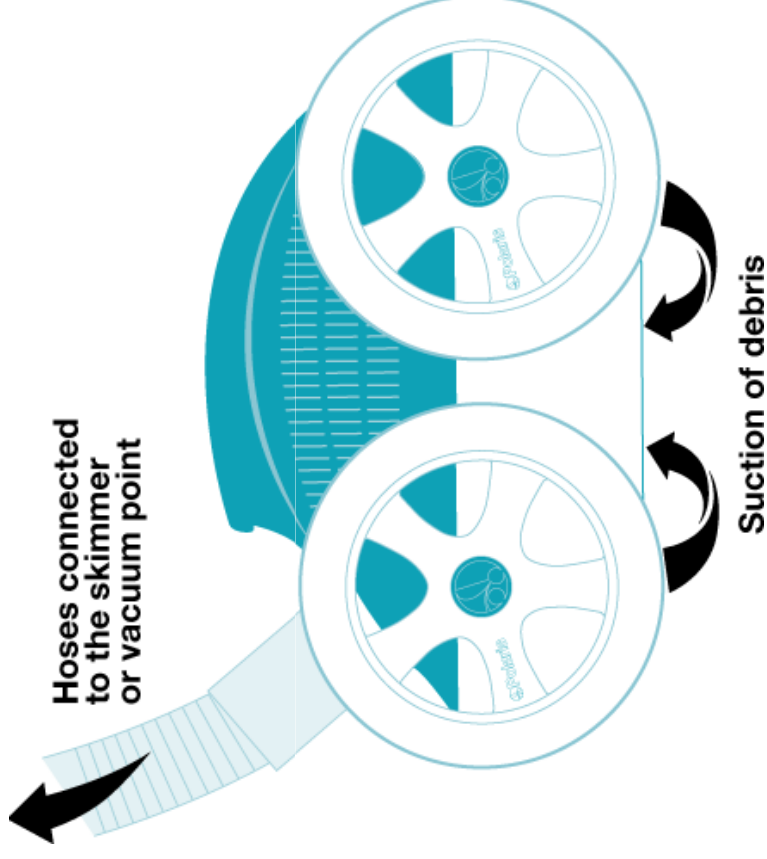



2. Comparative guide to suction cleaners

 <p>Polaris ATV</p>	Fast moving without jamming combined with optimum suction.	Hydraulic suction	Filter pump	Turbine	Random and automatic backward	10 m/min	Pool filter or Polaris LCS leaf trap	<ul style="list-style-type: none"> • Cleans any type of pool. • Moves smoothly without jamming. • Suction power adjustment device. 	726,98-€ before tax
 <p>Polaris 140</p>	Innovative magnetic movement system for dual-action cleaning.	Hydraulic suction	Filter pump	Magnetic movement	Random	10 m/min	Pool filter or Polaris LCS leaf trap	<ul style="list-style-type: none"> • Futuristic design. • Quick and easy to install. 	444,38-€ before tax



3. Presentation of models available

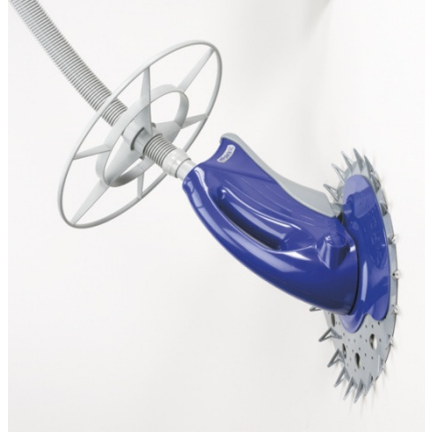



Polaris140 /Raptor

⇨ **POLARIS**
140/Raptor:
Innovative magnetic
movement system
for dual action
cleaning.





Polaris140 /Raptor

GENERAL CHARACTERISTICS		TECHNICAL CHARACTERISTICS	
System	Hydraulic suction	Pump power	3/4 hp
Motorisation	Pool filtration System	Min pump flow rate	11 m ³ /h
Suction	Magnetic movement	Adjustable suction	Automatic or manual
Installation	Vacuum point or skimmer	Cleaner pipe line	Flexible hoses or pipes
Movement	Random	Connection	Standard 1/4 turn
Use	3 to 4 hours daily	Options	LCS / Revolve-it / Unicover
Programming	Exactly the same as filtration	Suction diameter	4 cm
Debris capture	Pool filter or LCS POLARIS	Hole density bag	Depending on pool filter
Type of debris	Dust and grit, sand, gravel, leaves	Displacement speed	Approx. 10 m/min.
Pool dimensions	10 m x 5 m (allow for extension as well, max. 3 x 1 m)	Cleaner weight	2.3 kg
Guarantee	2 years	Standard hose length	12 m (12 x 1 m)



Polaris140 /Raptor

→ **Product benefits:**

- Futuristic design
- Quick and easy to install on the skimmer or vacuum point

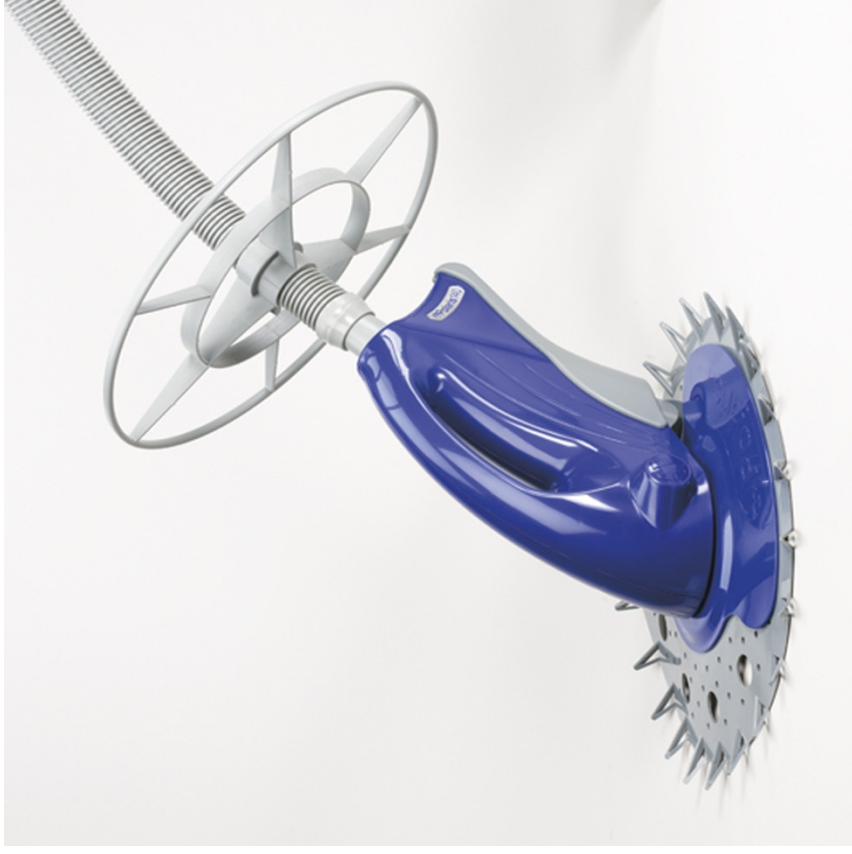



PART 2: TECHNICAL TIPS & HINTS

How to set a Polaris
suction cleaner correctly.



Standard settings (140/Raptor)

1/ Adjust the hose length to suit the pool

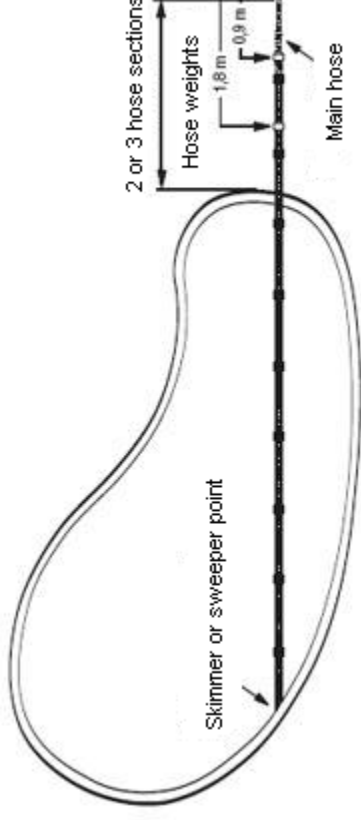

2/ Adjust the flow rate

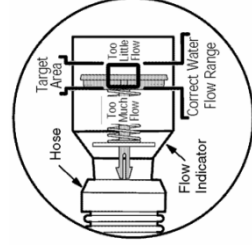
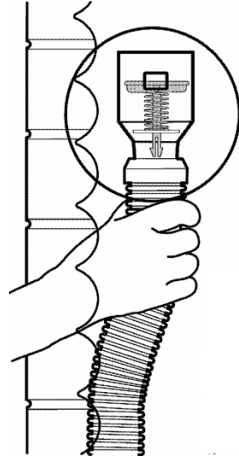

⇨ If too low:

- Set the wall valve
- Check and if necessary clean the pump pre-filter
- Close the skimmers

⇨ If too high:

- Set the wall valve
- Open the skimmer



Special settings (140/Raptor)

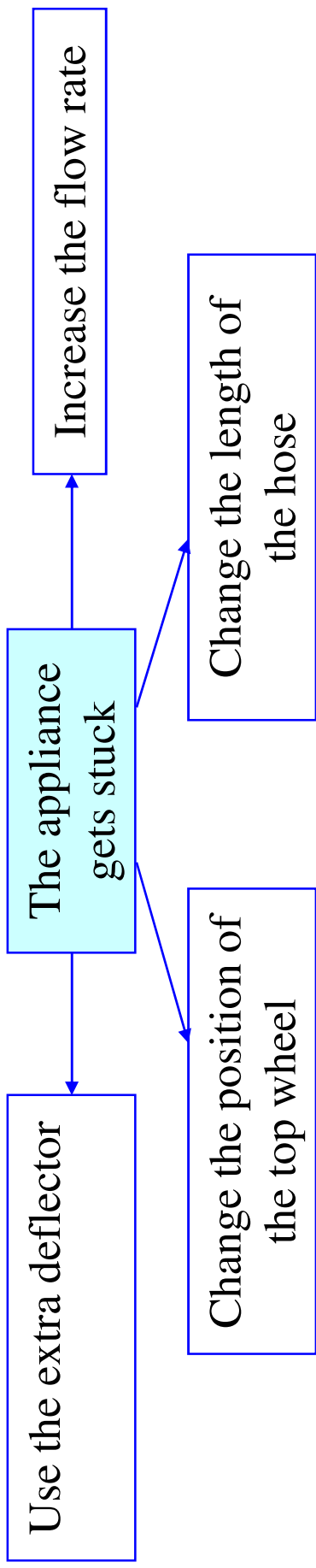



Special settings (140/Raptor)

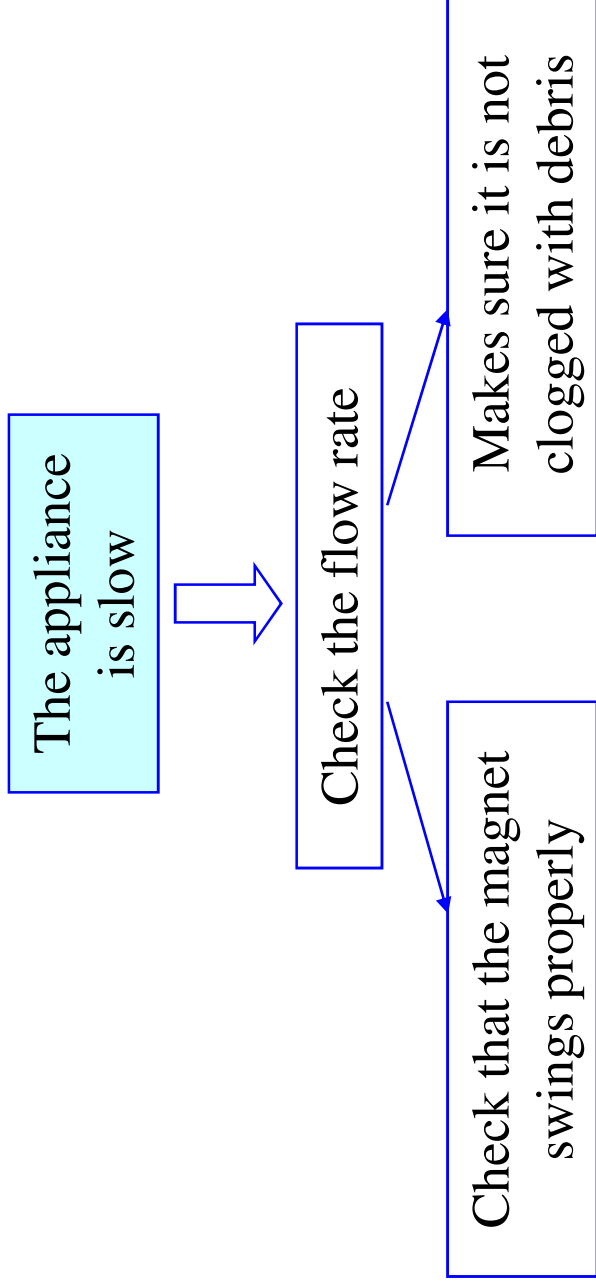



Special settings (140/Raptor)

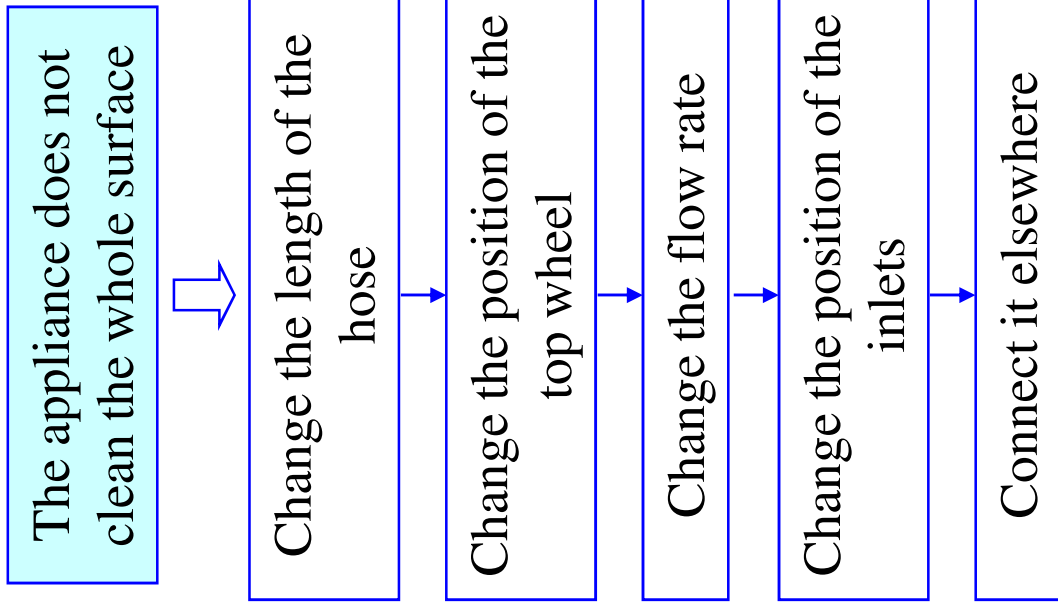



PART 3: After Sales Service: ASSEMBLY / DISMANTLING

Solving the most common
problems.



Repairs

Polaris140/Raptor

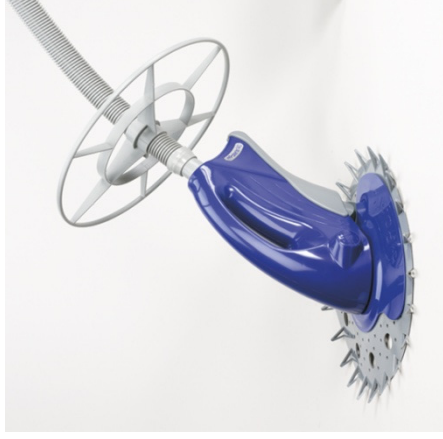



Repairs: Polaris140 /Raptor

⇒ **Removing the cover:**

- Undo the screws and separate the 2 parts of the cover **(1)**
- Take the cover off the body **(2)**





Repairs: Polaris140 /Raptor

⇒ Check the condition of the main suction nozzle:

- Remove the side screws and remove the socket **(1)**

👉 Check the condition of the gasket **(2)**

👉 Check the mobility of the ball valve **(3)**

If it moves with difficulty or not at all, 2 possible causes:

→ **Defective magnets:** Make sure the magnet protective cover is in good condition **(3)**

→ **Stop limiter not working:** to replace it, undo the 2 screws to remove the guard and remove the axle and ball valve **(4)**





Repairs: Polaris140 /Raptor

⇒ **Check the condition of the secondary suction nozzle:**

- Unscrew as shown in the photograph **(1)**
- Release the spring stopper **(2)**
- Unscrew the stopper **(3)**

 **Check the condition of the membrane and replace if necessary (4)**

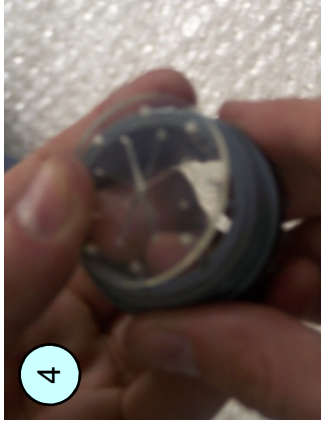
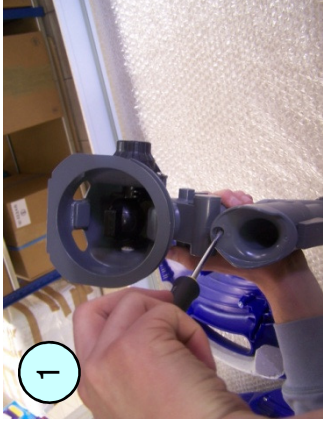



Part 4: Spare parts



Polaris140 /Raptor

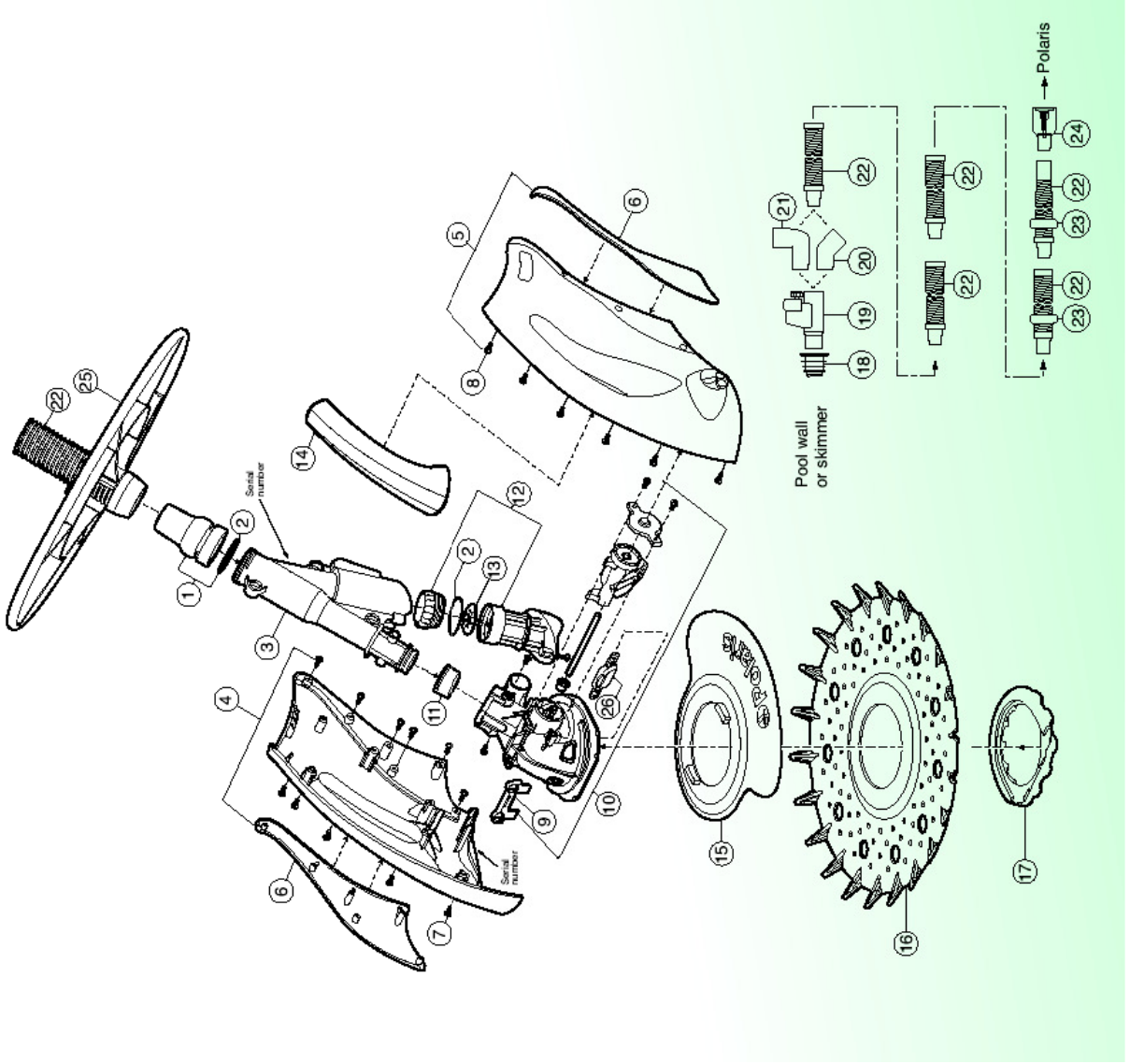



Polaris140 / Raptor

No.	Reference	Description
1	8-3000	Complete ball-and-socket joint
2	8-4610	O ring by-pass
3	8-5005	Frame for exchange only
4	8-2025	Left side cover
5	8-2020	Right side cover
6	8-2058	Decorative strip
7	9-100-5117	Stainless steel screw 8-32 x 3/8"
8	8-2061	Stainless steel screw 6 x 3/8"
9	8-4030	Ball valve stop
10	8-4005	Ball valve chamber
11	8-5010	Valve holder
12	8-4500	Spring stopper
13	8-4605	Diaphragm
14	8-2030	Float
15	8-6020	Skirt

16	8-6010	Surface disk
17	8-6005	Grey shoe
17	8-6007	White shoe (liner)
18	5-7100	Weir adaptor
19	5-7000	Flow regulator
20	5-7250	Elbow 45o
21	5-7200	Elbow 90o
22	5-5570	1 m standard suction hose section
	5-5600	1 m standard suction hose section (28 units)
23	5-7300	Hose weight
24	5-7050	Flow indicator
25	8-6050	Deflector
26	8-4075	Magnet protector